

FAMILY ACTIVITY TRAIL

Welcome to St Marie's Cathedral.

This church was built in 1850 and is home to many beautiful and interesting things. Follow this trail using the map below to see if you can find some of them.

- | | |
|---------------------------------|-----------------------------|
| 1. BAPTISMAL FONT | 7. THE TOMB OF FATHER PRATT |
| 2. WEST WINDOW | 8. THE SANCTUARY |
| 3. MORTUARY CHAPEL | 9. THE ALTAR |
| 4. THE NORTH TRANSEPT | 10. THE AMBO |
| 5. THE NORTH WINDOW | 11. ST JOSEPH'S CHAPEL |
| 6. THE BLESSED SACRAMENT CHAPEL | 12. THE LADY CHAPEL |
| | 13. THE HALLAM WINDOW |

Name: _____

Date: _____

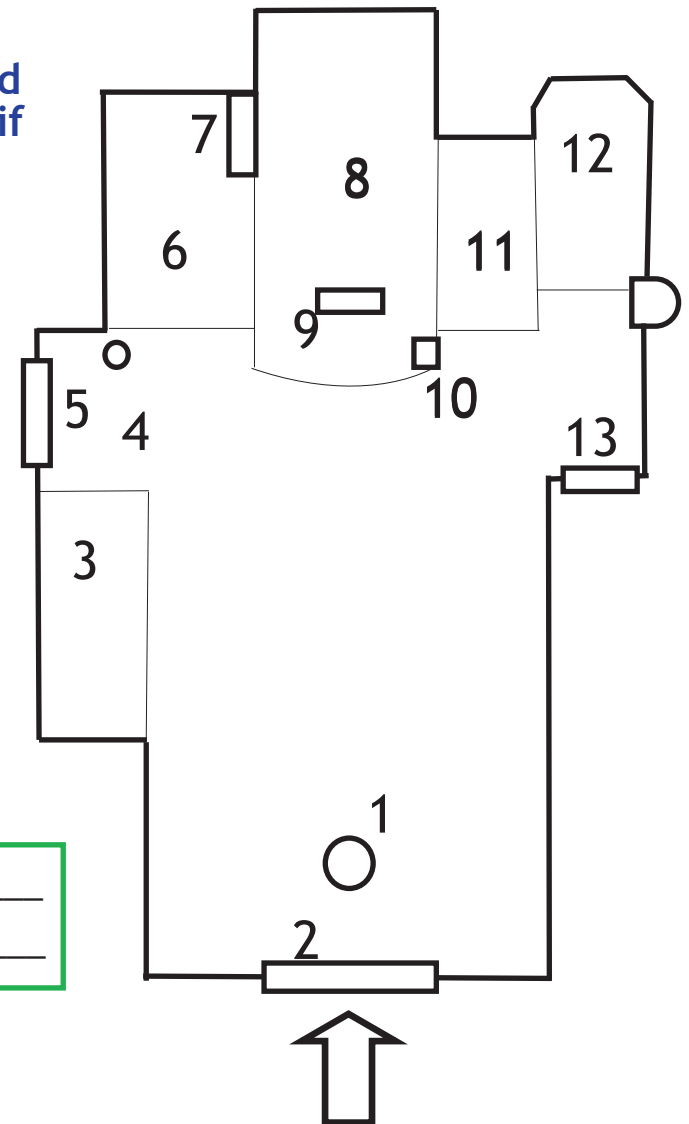

When you come in the Cathedral, the first thing you see is the baptismal font (1). This is where people are baptised.

How many sides does the font have? Count them and write the number down here.

Look at the West Window (2). Stained glass windows often tell stories. The bottom of the third panel of this window tells the story of Jonah and the Whale.

A whale once swallowed Jonah. He lived inside the whale's stomach for three days, but miraculously he survived.



HOW DOES BEING INSIDE THE CATHEDRAL MAKE YOU FEEL?



Happy?



Scared?



Peaceful?



Sad?



Sleepy?



Excited?

Go to the North Window (5). It shows pictures of saints with their names written beneath them. There are also some on the tiles in St Joseph's Chapel (11).

Can you find their names in the word search below?

Y D B T O Y X O S L I E H G L
M O K H U V N O N T X M O L B
A R K C L A R A E S N B A S A
R O Y V A G P D S J E N G T R
G T B N Y J P B H K E R N H B
A H E L I Z A B E T H A E O A
R E C A T H A R I N A W S M R
I A F D D M Y Y A K L J W A A
T U M I C H A E L B G G R S Q
A M A R I A M A G D A L E N A

CATHARINA
BARBARA
DOROTHEA

AGNES
CLARA
MARGARITA

MICHAEL
ELIZABETHA
MARIA MAGDALENA

Can you see a glass circle in the floor? Find it in the North Transept of the Cathedral (4).

What do you think is down there? _____



Use the answer sheet on the back to help you.

Go to the Blessed Sacrament chapel (6). Shh! This chapel is silent. The stained glass windows on the left look much newer than the others. Why do you think this is?



Use the answer sheet on the back to help you.

Write down the different colours you can see in the windows here

Stay in the Blessed Sacrament Chapel and go on to the next page



The altar in the Blessed Sacrament Chapel has lots of flowers on it (6).
Draw one of the flowers you see below.



There are over 200 angels featured at the Cathedral. Can you find the largest one outside St Joseph's Chapel (11). **What word would you use to describe this angel?**

The baptismal font (2) is made from the same material as the ambo and altar (9 & 10). **What do you think they are made out of?**



Use the answer sheet on the back to help you.



After WWII many Polish people settled in Sheffield. Go up the small staircase to the Lady Chapel (12) to see a Polish War Memorial.

Time to explore! Search for the parts of the Cathedral listed below and tick them off when you have found them.

- The column with angels in the Mortuary Chapel (3)
- A pelican on the altar (9)

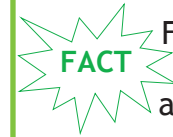

For Catholics, a mother pelican feeding its little ones is a symbol of Christ.

- The *Cathedra* or Bishop's chair in the Sanctuary (8)
- A dog sitting at the feet of Father Pratt on his tomb (7)

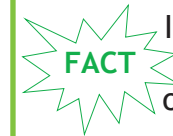

It was a medieval tradition to have a stone dog on the tombs of people who died in peace

When joined together the words below make up important parts of the Cathedral. Draw a line from a word on the right to the word on the left that matches.

- | | |
|---------------|------------------|
| GUARDIAN | PRATT |
| STAINED GLASS | FONT |
| FATHER | ANGEL |
| BAPTISMAL | CHAPEL |
| BLESSED | WINDOW |
| MORTUARY | SACRAMENT CHAPEL |

Find a date on the Hallam Window (13). **Why do you think this date is important?**



Use the answer sheet on the back to help you.

What part of the Cathedral do you like the best?



ANSWER SHEET

1. The baptismal font has 6 sides.
2. Down the glass hole there is a crypt where the first Bishop of Hallam is buried.
3. The stained glass windows in the Blessed Sacrament Chapel are newer because during WWII a bakery nearby was hit by a bomb and the heat from the burning sugar destroyed the original windows.
4. The baptismal font, ambo and altar are all made of Polish sandstone.



5. The date on the Hallam Window is 1980 and this is important because it is the year St Marie's became a Cathedral.